

Drop-In And Plug-In Battery Connector Change Notice

To better serve all AirWire customers and authorized dealers, the battery connector has been changed on all Drop-In and Plug-In decoders. This change is effective on July 1, 2016. This sheet explains the change and provides a brief background for why it was done. If you have any questions, contact CVP Products directly.

Why The Change? With the release of the new BATT2 battery pack, CVP Products has adopted the polarization used on batteries from Cordless Renovations (CR). This will insure a trouble-free transition from the weaker CR battery to the more powerful, longer lasting CVP battery.

Which Models Are Changing? DROP-IN Models GP38, SD70, NW2, GP30, SD40, GP7/9, F3A/B, PA/B and the Plug-In K27/C19 and all subsequent releases to either series.

What's Changing? All shipments of the AirWire Drop-In and Plug-In decoders will use a different type of battery input connector that will match to the new BATT2 battery pack. Users will not have to solder a connector to the battery.

What About Older Decoders? Can I Use The New Pack? Yes. But you must use a special adapter cable (see below) or change the connector on the old decoders.

OLD Drop-In & Plug-In Decoders

With JST Plug and User Installed JST Battery Socket

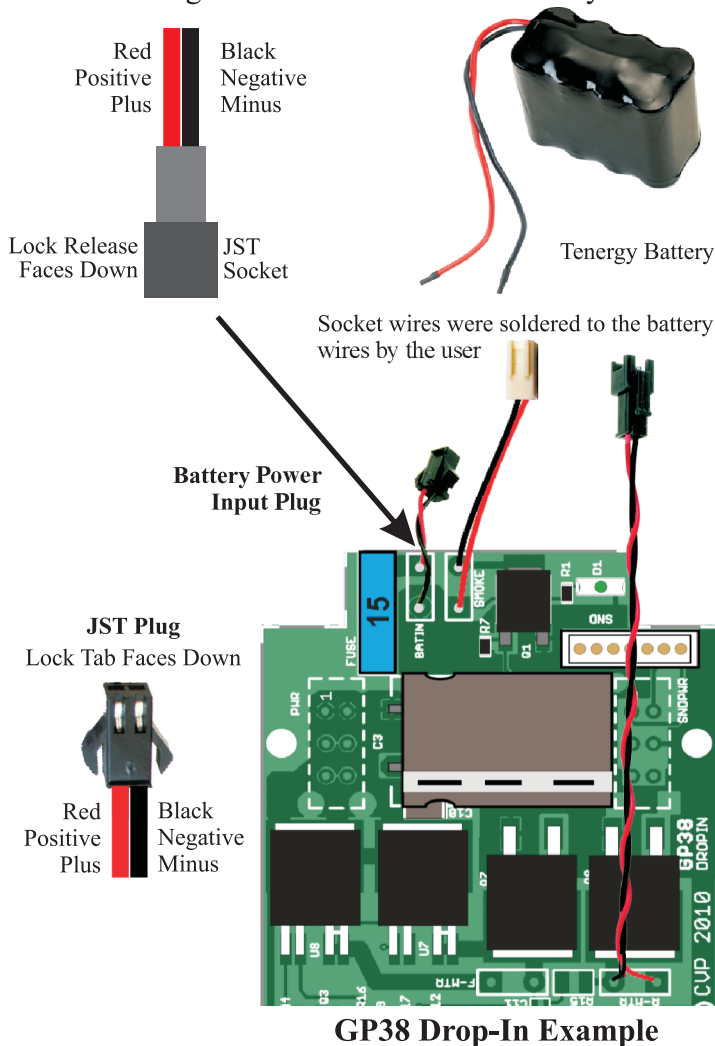

NEW Drop-In & Plug-In Decoders

With JST Socket To Match BATT2 Plug

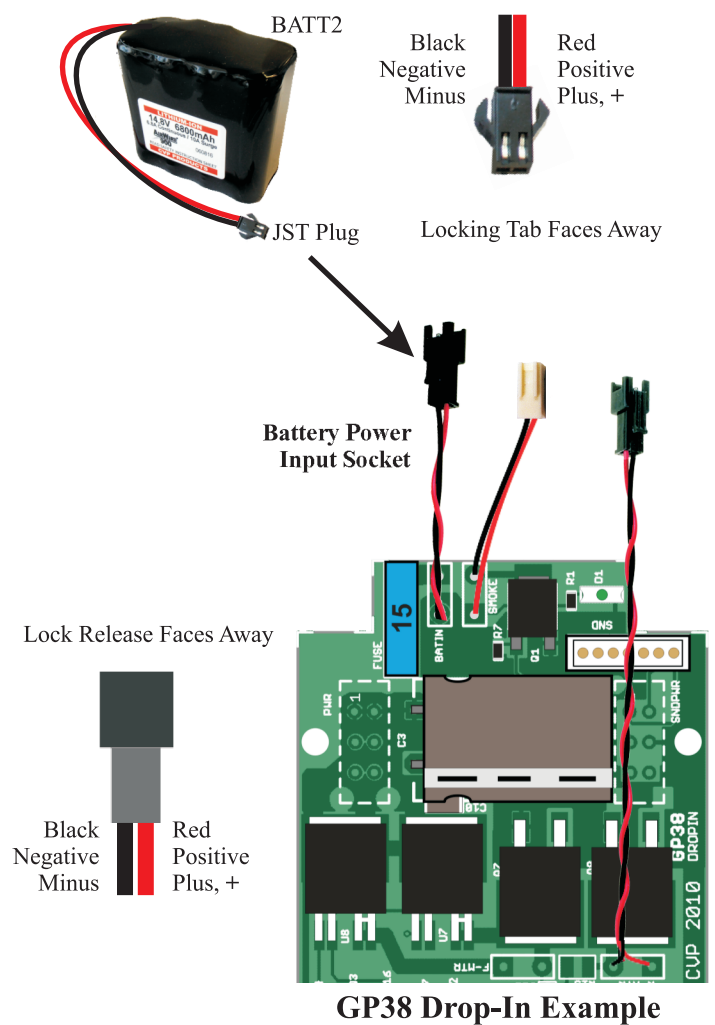

Battery Adapter Cable

Lock Release Faces Down (both ends)



The adapter can be built using two individual JST socket pigtailed or can be purchased direct from CVP Products.